

INFACO[®]

HEDGE TRIMMER **THD600/700P3**



ORIGINE
FRANCE[®]
GARANTIE

BVcert.6152145

ORIGINAL USER GUIDE - EN



PW3, a multi-function handle	4
Compatible tools	5
Precautions before use	6
Personal protection equipment	6
Protection of the environment	6
General product view	7
Specifications	7
Compatible batteries	8
User guide	9
Tool gap adjustment	13
Precautions for use and safety	14
Servicing and maintenance	16
Safety instruction	19
Warranty conditions	20
Advice	21
Troubleshooting	22
Technical information	25

PW3, A MULTI-FUNCTION HANDLE

Hand tools



PW3
+ TR9



PW3
+ SC160P3



PW3
+ PWMP3
+ PWP36RB



PW3
+ THD600P3



PW3
+ THD700P3

Pole tools



PW3
+ PW930P3
+ SC160P3



PW3
+ PW930P3
+ TR9



PW3
+ PW930P3
+ THD600P3



PW3
+ PW930P3
+ THD700P3



PW3
+ PS1P3 (sardage)



PW3
+ PB100P3 (hoeing)
+ PB150P3 (hoeing)
+ PB220P3 (hoeing)
+ PN370P3 (sweeping)



PW3
+ EP1700P3



PW3
+ EC1700P3



PW3
+ V5000P3EF



PW3
+ V5000P3ET



PW3
+ V5000P3AF

COMPATIBLE TOOLS

REFERENCE	DESCRIPTION
THD600P3	Double hedge-trimmer, blade length 600mm.
THD700P3	Double hedge-trimmer, blade length 700mm.
TR9	Arborists chainsaw, maximum cutting capacity Ø150mm.
SC160P3	Saw head, max cutting capacity Ø100mm.
PW930P3	Carbon extension, length 930mm.
PW1830P3	Carbon extension, length 1830mm.
PWT1650P3	Carbon extension, length 1650mm.
PS1P3	Fixed tying pole 1480mm.
PB100P3	Fixed hoe pole 1430mm Cutting head Ø100mm.
PB150P3	Fixed hoe pole 1430mm Cutting head Ø150mm.
PB220P3	Fixed hoe pole 1430mm Cutting head Ø200mm.
PN370P3	Fixed sweeping pole 1430mm Brush Ø370mm.
PWMP3 + PWP36RB	De-cankering tool (mill diameter 36mm)
PWMP3 + PWP25RB	De-cankering tool (file diameter 25 mm)
EP1700P3	Desuckering tool (telescopic pole 1200mm to 1600mm).
EC1700P3	Blossom thinner (telescopic pole 1500mm to 1900mm).
V5000P3EF	Olive harvester (fixed pole 2500mm).
V5000P3ET	Olive harvester (telescopic pole 2200mm to 2800mm).
V5000P3AF	Alternative olive harvester (fixed pole 2250mm)

PRECAUTIONS BEFORE USE



WARNING. Read all the safety warnings and all the instructions. Failing to heed warnings and follow instructions may lead to an electric shock, a fire and/or serious injury.

Keep all warnings and instructions for future reference. The term “tools” in the warnings refers to your battery powered electric tool (with power cord), or your tool operating on a battery (without power cord).

PERSONAL PROTECTION EQUIPMENT

	Read the instructions for use carefully, especially the safety instructions.
	The wearing of a hard hat, eye and ear protection is MANDATORY
	Hand protection using cut-prevention work gloves.
	Foot protection using safety footwear.
	Face protection using a visor
	Body protection, using cut protection overalls.
	IMPORTANT! Extensions can be made of conductive materials. Do not use near sources of electricity or electric wires
	IMPORTANT! Do not approach any part of the body to the blade. Do not remove the cut material or hold the material to be cut while the blades are moving.

PROTECTION OF THE ENVIRONMENT



Observe all country-specific waste disposal rules and regulations.

- > Power tools must not be disposed of with household refuse.
- > The device, accessories and packaging must be taken to a recycling centre.
- > Ask the approved INFACO dealer for up-to-date information on the eco-compatible elimination of waste.



GENERAL PRODUCT VIEW



SPECIFICATIONS

REFERENCE	THD600	THD700
Rated power supply	48VCC	
Max power	1300W	
Weight	3440g	3650g
Length	570mm	700mm
Speed	3200 cuts / mn	

These specifications are given as an indication only. Under no circumstances may they be considered as contractually binding. They are subject to modification without prior notice in the interests of product development.

Patented equipment

COMPATIBLE BATTERIES



820Wh battery
L850B

Cable compatibility
L856CC



120Wh battery
831B

Cable compatibility
825S



500Wh battery
L810B

Cable compatibility
PW225S



150Wh battery
731B

Cable compatibility
PW225S (requires fuse
replacement by 539F20).

USER GUIDE

First use

The first time you use the equipment, we strongly recommend you to ask the advice of your dealer, who is qualified to give you all the advice you need for correct use and optimum performance. **It is imperative to carefully read the device and accessory user manuals before handling or connecting the device.**

Handle assembly





Disconnect the power cord



> Connect the power cable

> Connect the battery



1st start-up: 2 short presses on the trigger = ON

Exit from standby mode: 2 short presses on the trigger = ON

Normal operation: 1 long press on the trigger = ON

Trigger release: OFF

It is mandatory to hold it with both hands

Storage and transport



For the transport, storage, servicing, maintenance of the tool, or any other operations not related to tool function operations, **it is imperative to disconnect the device.**



Assembly on a pole

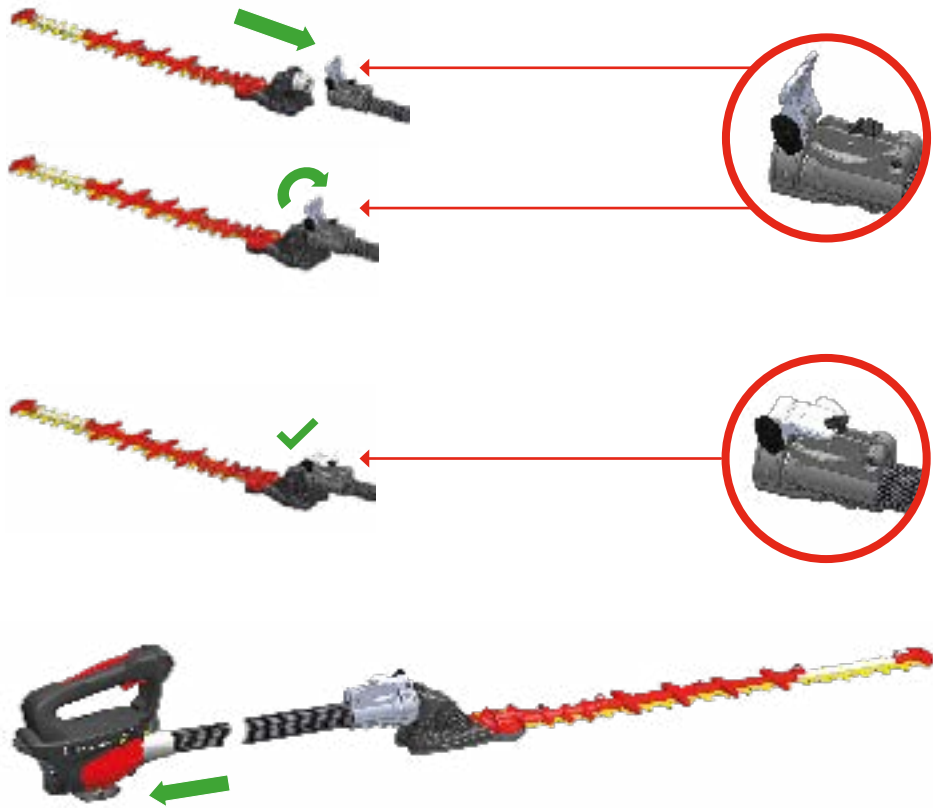

> Tighten the wing nut



TOOL GAP ADJUSTMENT



It is imperative to disconnect the machine.



No movements

GAP OK

Presence of movements

ADJUST
THE GAP



PRECAUTIONS FOR USE AND SAFETY

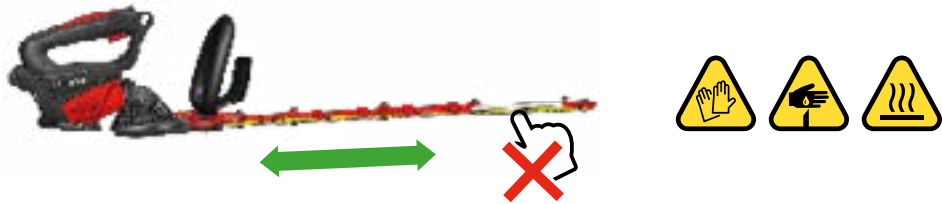

It is mandatory to hold it with both hands



Warning about risks when working at heights using a ladder.

High-risk work configuration not recommended.

We recommend the use of the extension (option) for all work at heights. In order to prevent any risk of falls and other accidents.



If you use any **external resources to the supply of the INFACO** to carry out your work, it is **IMPERATIVE to place the tool on the ground.**

Disconnect the cord from the battery quick connector before moving from A to B.



For the transport, storage, servicing, maintenance of the tool, or any other operations not related to tool function operations, it is imperative to disconnect the device.



Disconnect before transport and storage



Disconnect before transport and storage



SERVICING AND MAINTENANCE

All servicing and maintenance operations must be carried out with the tool disconnected from all power sources:

Adapt the servicing frequencies to your tool use.

Occasional use, space out the frequency. Intensive use, increase the frequency.

		Before starting work	At the end of the day	Each time the battery is charged	Once per week	Once per month	Once per year	In the event of damage	In the event of a malfunction	When necessary
Complete machine	Visual inspection of its condition	X	X							
	Cleaning		X							X
	Inspection by the dealer							X	X	
Accessory assembly	Cleaning and lubrication				X					X
	Adjust the gap	X	X							X
Blade holder gap	Inspection		X							
Blade holder	Visual inspection of its condition	X								
	Cleaning and lubrication		X							
	Sharpening					X				
	Replacement							X	X	
Hedge-trimmer head	Gap check		X							
	Lubrication				X					X
	Inspection by the dealer							X	X	
Power cord	Visual inspection of its condition					X		X	X	
Battery	Visual inspection of its condition			X	X			X	X	
Vest	Visual inspection of its condition						X	X	X	
Handle	Visual inspection of its condition	X	X							

Blade holder lubrication

Recommended products: Lithium grease ref: 352B - Grease ref: B400G

Always disconnect your tool from the battery.



Blade holder lubrication

Recommended products: Grease ref: LUB

Always disconnect your tool from the battery.



Sharpening

Always disconnect your tool from the battery.

If you have no experience in blade sharpening, it is strongly recommended to ask for your dealers' help, as they are authorised to sharpen your hedge-trimmer blade.

Recommended equipment:

- Flat file for hard steel



Recommended sharpening:

- Place the file on the tooth and comply with the existing sharpening angle. Apply a movement towards the contact surface of the two blades.

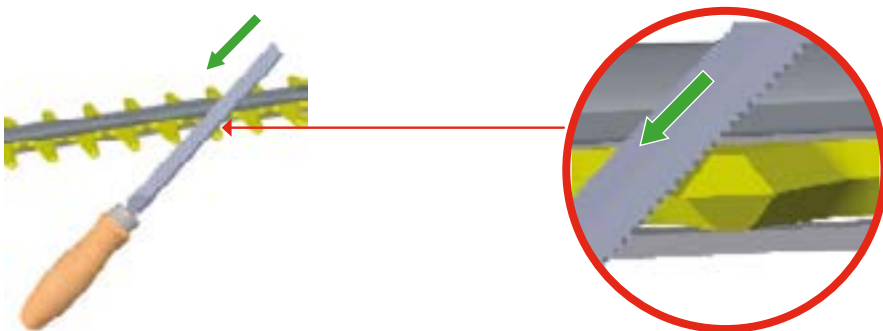

SAFETY INSTRUCTION

IMPORTANT. To reduce the risk of electric discharges, injuries and fire when using electric tools, follow the fundamental safety measures indicated below. Read and follow these instructions before using the tool, and keep the safety instructions!

Outside operations related to the use of the tool, your tool and its accessories must be disconnected and stored in their relevant packaging.



It is imperative to disconnect your tool from all power sources for the following operations:

- **Servicing.**
- **Battery charging.**
- **Maintenance.**
- **Transport.**
- **Storage.**

When the tool is running, always remember to keep the hands away from the accessory head being used. Do not work with the tool if you are tired or feeling unwell. Wear the specific recommended personal protection equipment for each accessory. Keep the equipment out of the reach of children or visitors.



Do not use the tool if there is a risk of fire or explosions, for example in presence of flammable liquids or gases.

Never carry the charger by the cord, and do not pull on the cord to disconnect it from the socket.



Keep the cord away from heat, oil and sharp edges.

Never use the tool at night or in bad light without setting up additional lighting. When using the tool, keep both feet on the ground and keep as much balance as possible.



Caution: extensions can be made of conductive materials. Do not use near sources of electricity or electric wires.

WARRANTY CONDITIONS

Your tool has a two year warranty for manufacturing defects or faults.

The warranty applies to the normal use of the tool and does not cover:

- **damage due to poor maintenance or lack of maintenance,**
- **damage due to incorrect use,**
- **wear parts,**
- **tools that have been taken apart by unauthorised repairers,**
- **external factors (fire, flood, lightning, etc.),**
- **impacts and their consequences,**
- **It tools used with a battery or charger other than those of the INFACO brand.**

The warranty is only applicable when the warranty has been registered with INFACO (warranty card or online declaration on www.infaco.com).

If the warranty declaration was not made when the tool was purchased, the factory departure date will be used as the warranty start date.

The warranty covers factory labour but not necessarily dealer labour. The repair or replacement during the warranty period does not extend or renew the initial warranty.

All failings regarding the storage and safety instructions will void the manufacturer's warranty.

The warranty cannot entitle to compensation for:

The possible immobilisation of the tool during repairs.

All work carried out by a person other than approved INFACO agents will cancel the tool warranty.

The repair or replacement during the warranty period does not extend or renew the initial warranty.

We strongly recommend INFACO tool users to contact the dealer that sold them the tool in the event of a failure.

To avoid all disputes, please note the following procedure:

- **Tool still under warranty, send it to us carriage paid and we will pay the return.**
- **Tool no longer under warranty, send it to us carriage paid and the return will be at your expense by cash on delivery. If the cost of the repair were to exceed € 80 excluding VAT, you will be supplied with a quote.**

ADVICE

Keep your work area tidy. Clutter in work areas increases risks of accidents.

Take into account the work zone. Do not expose electric tools to rain. Do not use electric tools in a damp or wet environment. Make sure the work area is properly lit. Do not use electric tools near inflammable liquids or gases.

Protect yourself from electric shocks. Avoid bodily contact with surfaces connected to the earth, such as battery chargers, electric multi-plugs, etc.

Keep away from children! Do not allow third parties to touch the tool or cable. Keep them away from your work area.

Store your tools in a safe location. When not in use, tools must be stored in a dry, locked location in their original packaging and out of the reach of children.

Wear suitable work clothing. Do not wear loose-fitting clothing or jewellery. It could be caught up in moving parts. When working in the open air, wearing rubber gloves and non-slip sole footwear is recommended. If your hair is long, wear a hair net.

Wear protective eye-wear. Also wear a mask if the work being carried out generates dust.

Protect the power cord. Do not carry the tool using its cord and do not pull on the cord to disconnect it from the socket. Protect the cord from heat, oil and sharp edges.

Maintain your tools carefully. Regularly check the plug and power cord condition and, if they are damaged, have them replaced by a recognised specialist. Keep your tool dry and free of oil.

Remove the tool keys. Before starting the machine, make sure the keys and adjustment tools have been removed.

Check your tool for damage. Before reusing the tool, carefully check that the safety systems or slightly damaged parts are in perfect working order.

Have your tool repaired by a specialist. This tool is compliant with applicable safety rules. All repairs must be carried out by a specialist and only using original parts, failure to do so could result in serious risks to user safety.

TRUBLESHOOTING

DISRUPTIONS	CAUSES	SOLUTIONS
Poor cuts	Not enough grease	Lubricate the hedge-trimmer following the procedure
	Blade holder wear	Contact your dealer
Noise in the extension	Extension guide damaged	Contact your dealer
The machine will not start	Battery discharged	Recharge the battery
	No power supply	Re-connect the machine.
	Other	Contact your dealer.
Unexpected machine stoppages	Battery discharged	Recharge the battery.

DEALER PART

Part to be kept by the dealer.

Serial number > Ref >

Name >

First name >

Company name >

Full address >

City >

Postcode >

Phone number >

Purchase date > / /

Remarks >

customer signature

TO BE RETURNED TO INFACO

To validate the warranty, **REGISTER IMMEDIATELY ONLINE ON** : www.infaco.com, your warranty declaration or send this form filled out **IN BLOCK CAPITALS AS SOON AS THE TOOL IS PURCHASED.**

Name > Prénom >

Company name >

Full address >

City > Postcode >

Phone number >

Email >

Purchase date > / /

Serial number v - Ref >

--	--	--	--	--	--	--	--

Remarks >

- Orchards Oil production
 Vine growing Parks & gardens

Dealer's stamp

Serial number

DEALER

To be kept by the dealer
for the customer
file
customer file



**EQUIPMENT MANUFACTURED
IN FRANCE**



Manufacturer > *INFACO S.A.S. - 81140 CAHUZAC-SUR-VÈRE (FRANCE)*

Type > *POWERCOUPE PW3 THD*

Ref > *THD600P3 / THD700P3*

Weight > *THD600 3300g / THD700 3400g*

Maximum power > *1300W*

Battery rated voltage > *48 Volts*

These specifications are given as an indication only. Under no circumstances may they be considered as contractually binding. They are subject to modification without prior notice in the interests of product development.

TECHNICAL INFORMATION OR CUSTOMER SERVICE

INFACO S.A.S.

Bois de Roziès

81140 CAHUZAC-SUR VÈRE France

Phone: (+33) 05 63 33 91 49 - *Fax:* (+33) 05 63 33 95 57

Email: contact@infaco.fr

Technical videos available on the website: www.infaco.com