

# INFACO<sup>®</sup>



OLIVE HARVESTER

## E5000 12V2 / E5000 12V2T



ORIGINE  
**FRANCE<sup>®</sup>**  
GARANTIE

BVcert.6152145

OTHER LANGUAGES

ORIGINAL USER GUIDE - **EN**





Precautions before use	4
Personal protection equipment	4
Protection of the environment	4
General product view	5
Specifications	5
User guide	6
Adjustment of the telescopic pole	10
Precautions for use and safety	11
Servicing and maintenance	12
Safety instruction	14
Warranty conditions	15
Advice	16
Troubleshooting	17
Technical information	21
Déclaration de conformité CE	22









# PRECAUTIONS BEFORE USE



**WARNING.** Read all the safety warnings and all the instructions. Failing to heed warnings and follow instructions may lead to an electric shock, a fire and/or serious injury.

**Keep all warnings and instructions for future reference.** The term “tools” in the warnings refers to your battery powered electric tool (with power cord), or your tool operating on a battery (without power cord).

# PERSONAL PROTECTION EQUIPMENT

	Read the instructions for use carefully, especially the safety instructions.
	The wearing of a hard hat, eye and ear protection is MANDATORY
	Hand protection using cut-prevention work gloves.
	Foot protection using safety footwear.
	Face protection using a visor
	Body protection, using cut protection overalls.
	IMPORTANT! Extensions can be made of conductive materials. Do not use near sources of electricity or electric wires
	IMPORTANT! Do not approach any part of the body to the blade. Do not remove the cut material or hold the material to be cut while the blades are moving.

# PROTECTION OF THE ENVIRONMENT



Observe all country-specific waste disposal rules and regulations.

> Power tools must not be disposed of with household refuse.

> The device, accessories and packaging must be taken to a recycling centre.



> Ask the approved INFACO dealer for up-to-date information on the eco-compatible elimination of waste.

# GENERAL PRODUCT VIEW

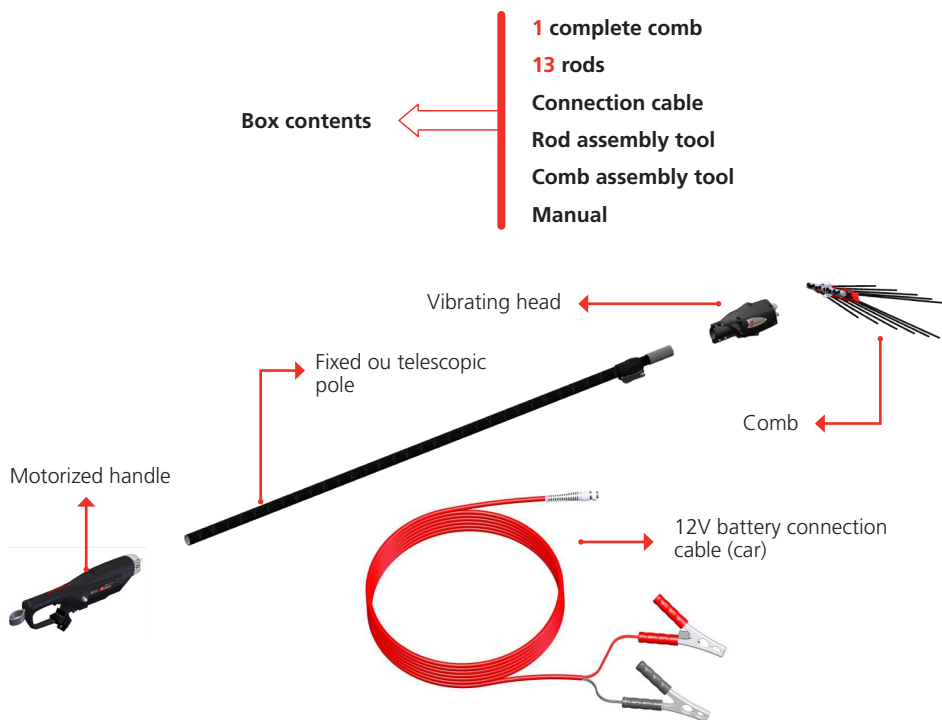

# SPECIFICATIONS

REFERENCE	E5000 12V2	E5000 12V2T
Rated power supply	12VCC	
Max power	200W Max	
Weight	3000g	3250g
Length	2,30m	2,30m à 3,30m
Speed	1200 oscillations / mn	

*These specifications are given as an indication only. Under no circumstances may they be considered as contractually binding. They are subject to modification without prior notice in the interests of product development.*

*Patented equipment*

# USER GUIDE

## First use

The first time you use the equipment, we strongly recommend you to ask the advice of your dealer, who is qualified to give you all the advice you need for correct use and optimum performance. **It is imperative to carefully read the device and accessory user manuals before handling or connecting the device.**

## Fitting the comb

**VPlease ask your dealer for advice on fitting the comb.  
Incorrect assembly can cause wear on the comb or rods**



The use of the INFACO (E710) screwdriver when tightening is strongly recommended to avoid damaging the tightening tips.

Comb assembly:

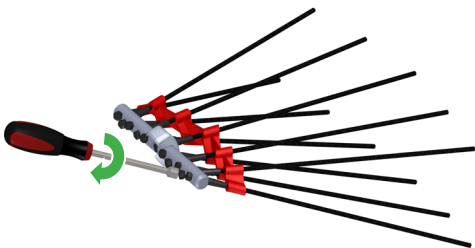
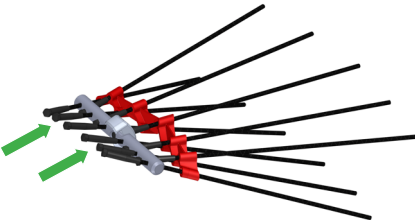
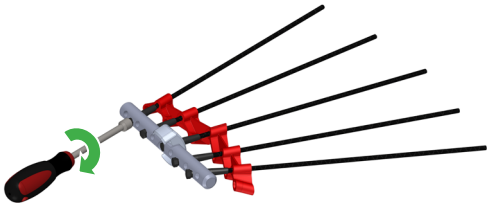
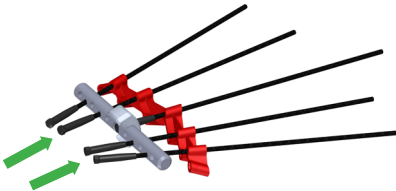
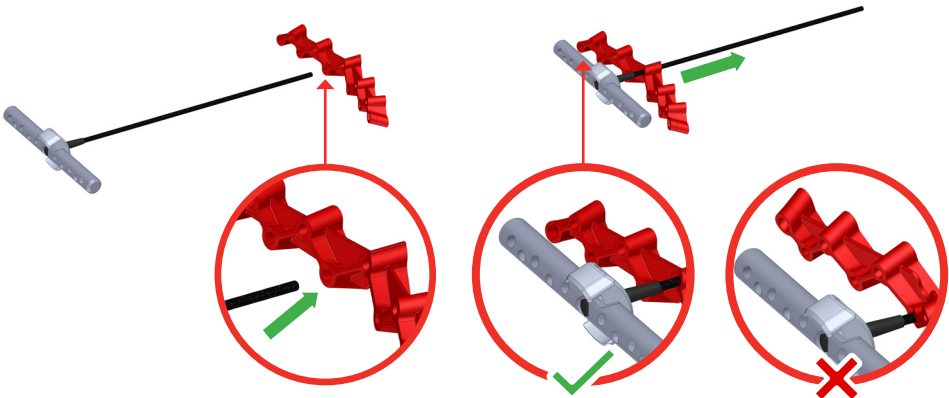

Comb attachment

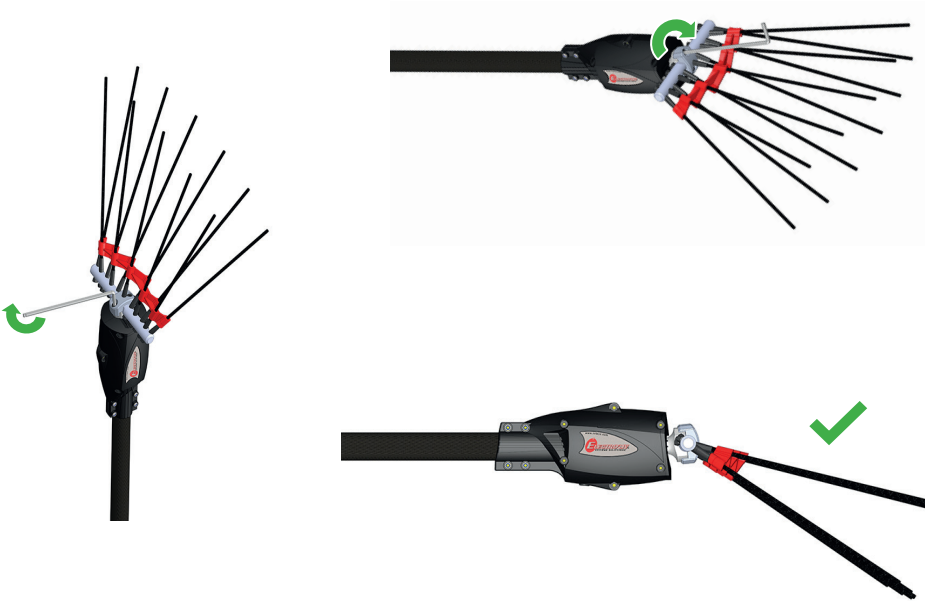
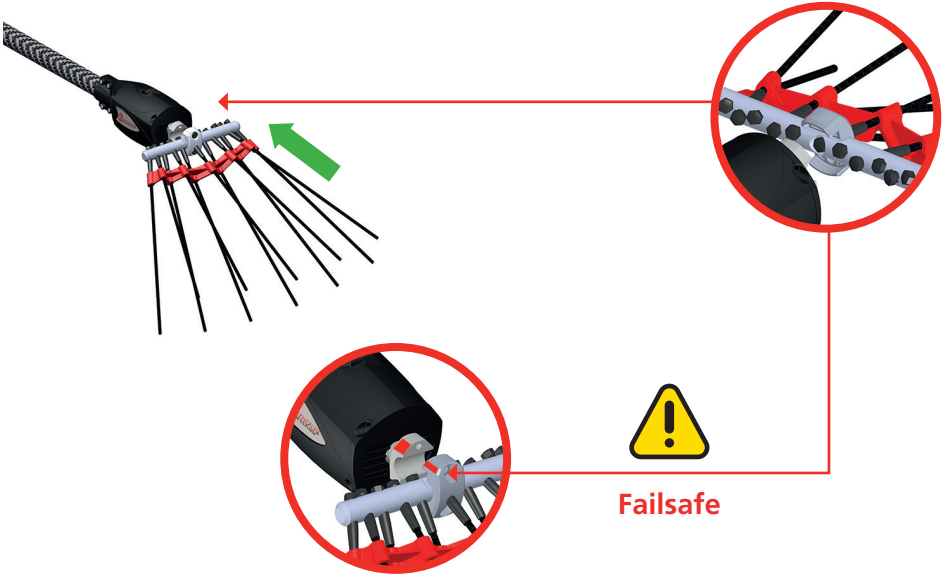



## Installation and connection



It is essential to carefully read the user manuals for the devices and accessories before connecting them.

## Using the machine

> Connect the power cable



> Start-up



# ADJUSTMENT OF THE TELESCOPIC POLE

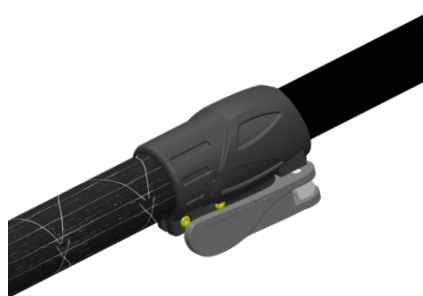
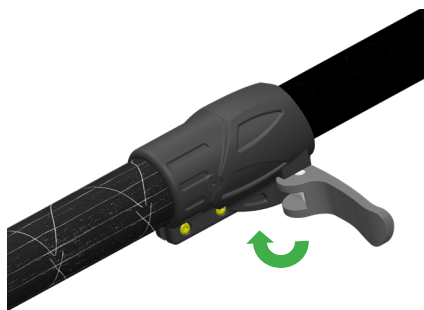
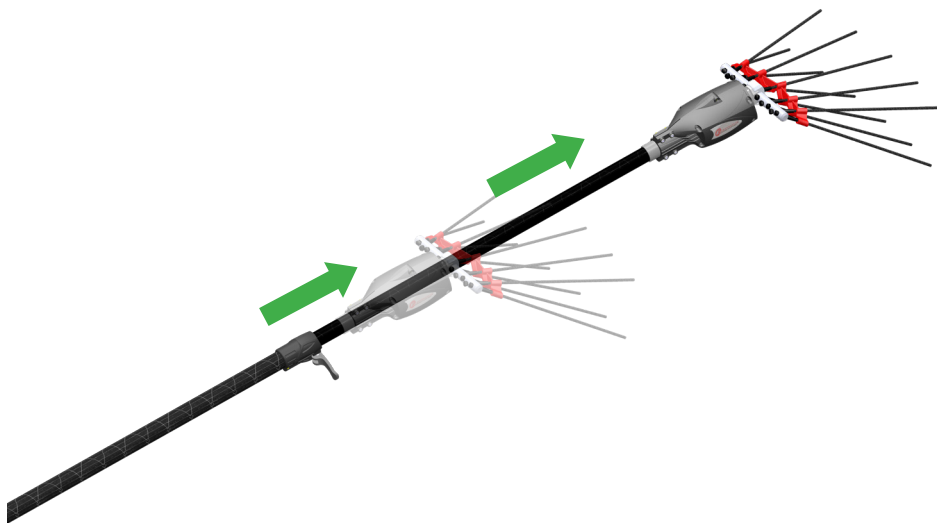
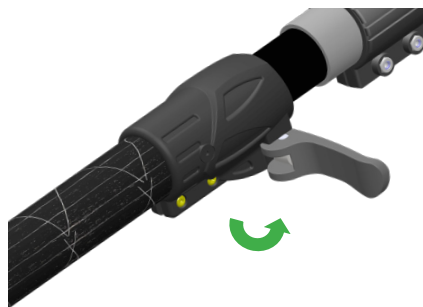
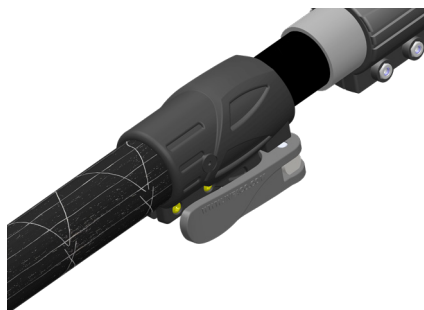

# PRECAUTIONS FOR USE AND SAFETY

The machine is fitted with an electronic board with thermal circuit-breaking. As soon as the head jams because of too strong resistance, the electronic board cuts the power to the motor and the red LED lights. To restart, place the switch in the "OFF" position, then switch it back to "ON". When the motor temperature is too high, the board cuts the motor power supply. To restart, carry out the previous operation.

When the machine starts, if there is significant vibration, **stop the machine immediately and check the comb fitting and tightening**. If the significant vibration persists, **stop the machine immediately and contact your nearest dealer**.

We also recommend that you keep the machine protection packaging for possible returns to the factory for after-sales operations.



For the transport, storage, servicing, maintenance of the tool, or any other operations not related to tool function operations, **it is imperative to disconnect the device**.



*Disconnect  
before transport  
and storage*



# SERVICING AND MAINTENANCE

<p>All servicing and maintenance operations must be carried out with the tool disconnected from all power sources:</p> <p>Adapt the servicing frequencies to your tool use.</p> <p>Occasional use, space out the frequency. Intensive use, increase the frequency.</p>		Before starting work	At the end of the day	Each time the battery is charged	Once per week	Once per month	Once per year	In the event of damage	In the event of a malfunction	When necessary
Complete machine	Visual inspection of its condition	×	×							
	Cleaning		×							×
	Inspection by the dealer							×	×	
Comb fixing	Inspection	×								×
Carbon rod	Visual inspection of its condition	×								
	Cleaning		×							
	Replacement							×		×
Vibrating head	Gap check		×							
	Lubrication	×								×
	Inspection by the dealer							×	×	
Power cord	Visual inspection of its condition					×			×	×
Handle	Visual inspection of its condition	×	×							

## Lubrication

Generously lubricate the vibrating head at least once every day, in the morning before starting to work.

Position the spray nozzle towards the ball and socket. Hold the spray can upright and then press. Grease the vibrating head at least once per day (lubrication without removing any parts).

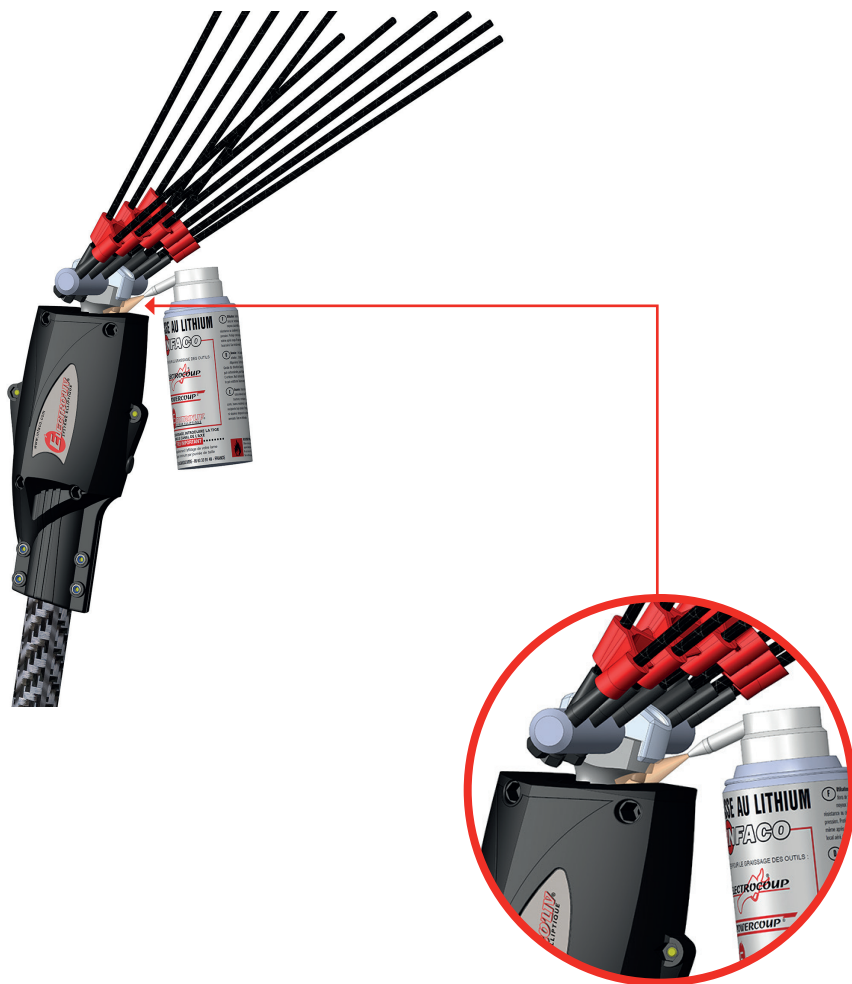

# SAFETY INSTRUCTION

IMPORTANT. To reduce the risk of electric discharges, injuries and fire when using electric tools, follow the fundamental safety measures indicated below. Read and follow these instructions before using the tool, and keep the safety instructions!

Outside operations related to the use of the tool, your tool and its accessories must be disconnected and stored in their relevant packaging.



It is imperative to disconnect your tool from all power sources for the following operations:

- **Servicing.**
- **Battery charging.**
- **Maintenance.**
- **Transport.**
- **Storage.**

When the tool is running, always remember to keep the hands away from the accessory head being used. Do not work with the tool if you are tired or feeling unwell. Wear the specific recommended personal protection equipment for each accessory. Keep the equipment out of the reach of children or visitors.



Do not use the tool if there is a risk of fire or explosions, for example in presence of flammable liquids or gases.

Never carry the charger by the cord, and do not pull on the cord to disconnect it from the socket.



Keep the cord away from heat, oil and sharp edges.

Never use the tool at night or in bad light without setting up additional lighting. When using the tool, keep both feet on the ground and keep as much balance as possible.



Caution: extensions can be made of conductive materials. Do not use near sources of electricity or electric wires.

# WARRANTY CONDITIONS

Your tool has a two year warranty for manufacturing defects or faults.

The warranty applies to the normal use of the tool and does not cover:

- **damage due to poor maintenance or lack of maintenance,**
- **damage due to incorrect use,**
- **wear parts,**
- **tools that have been taken apart by unauthorised repairers,**
- **external factors (fire, flood, lightning, etc.),**
- **impacts and their consequences,**
- **It tools used with a battery or charger other than those of the INFACO brand.**

**The warranty is only applicable when the warranty has been registered with INFACO (warranty card or online declaration on [www.infaco.com](http://www.infaco.com)).**

**If the warranty declaration was not made when the tool was purchased, the factory departure date will be used as the warranty start date.**

**The warranty covers factory labour but not necessarily dealer labour. The repair or replacement during the warranty period does not extend or renew the initial warranty.**

All failings regarding the storage and safety instructions will void the manufacturer's warranty.

The warranty cannot entitle to compensation for:

The possible immobilisation of the tool during repairs.

All work carried out by a person other than approved INFACO agents will cancel the tool warranty.

The repair or replacement during the warranty period does not extend or renew the initial warranty.

We strongly recommend INFACO tool users to contact the dealer that sold them the tool in the event of a failure.

To avoid all disputes, please note the following procedure:

- **Tool still under warranty, send it to us carriage paid and we will pay the return.**
- **Tool no longer under warranty, send it to us carriage paid and the return will be at your expense by cash on delivery. If the cost of the repair were to exceed € 80 excluding VAT, you will be supplied with a quote.**

## **ADVICE**

**Keep your work area tidy.** Clutter in work areas increases risks of accidents.

**Take into account the work zone.** Do not expose electric tools to rain. Do not use electric tools in a damp or wet environment. Make sure the work area is properly lit. Do not use electric tools near inflammable liquids or gases.

**Protect yourself from electric shocks.** Avoid bodily contact with surfaces connected to the earth, such as battery chargers, electric multi-plugs, etc.

**Keep away from children!** Do not allow third parties to touch the tool or cable. Keep them away from your work area.

**Store your tools in a safe location.** When not in use, tools must be stored in a dry, locked location in their original packaging and out of the reach of children.

**Wear suitable work clothing.** Do not wear loose-fitting clothing or jewellery. It could be caught up in moving parts. When working in the open air, wearing rubber gloves and non-slip sole footwear is recommended. If your hair is long, wear a hair net.

**Wear protective eye-wear.** Also wear a mask if the work being carried out generates dust.

**Protect the power cord.** Do not carry the tool using its cord and do not pull on the cord to disconnect it from the socket. Protect the cord from heat, oil and sharp edges.

**Maintain your tools carefully.** Regularly check the plug and power cord condition and, if they are damaged, have them replaced by a recognised specialist. Keep your tool dry and free of oil.

**Remove the tool keys.** Before starting the machine, make sure the keys and adjustment tools have been removed.

**Check your tool for damage.** Before reusing the tool, carefully check that the safety systems or slightly damaged parts are in perfect working order.

**Have your tool repaired by a specialist.** This tool is compliant with applicable safety rules. All repairs must be carried out by a specialist and only using original parts, failure to do so could result in serious risks to user safety.



# TROUBLESHOOTING

DISRUPTIONS	CAUSES	SOLUTIONS
<b>Significant abnormal vibrations</b>	Incorrect comb assembly	Refit the comb by following the procedure and contact the dealer if necessary.
	Incorrect comb tightening	Re-tighten the comb by following the procedure.
	Incorrect rod tightening	Re-tighten the rods by following the procedure.
	Rod wear	Check that one of the rod is not loose or damaged. Contact the dealer if necessary.
	Defective tool detection	Contact your dealer.
<b>Broken carbon rod</b>	Wear	Replace the broken and/or worn rod.
<b>Noise in the extension</b>	Extension guide damaged	Contact your dealer.
<b>The machine will not start</b>	Battery discharged	Recharge the battery.
	No power supply	Re-connect the machine.
	Other	Contact your dealer.
<b>Unexpected machine stoppages</b>	Too strong a pulse Mechanical jam	Change the work method or ask your dealer for advice. Restart by pressing the trigger once.
	Battery discharged	Recharge the battery.



# DEALER PART

Part to be kept by the dealer.

Serial number > ..... Ref > .....

Name > .....

First name > .....

Company name > .....

Full address > .....

.....

City > .....

Postcode > .....

Phone number > .....

Purchase date > ..... / ..... / .....

Remarks > .....

customer signature

## TO BE RETURNED TO INFACO

To validate the warranty, **REGISTER IMMEDIATELY ONLINE ON :**  
[www.infaco.com](http://www.infaco.com), your warranty declaration or send this form filled out  
**IN BLOCK CAPITALS AS SOON AS THE TOOL IS PURCHASED.**

Name > ..... Prénom > .....

Company name> .....

Full address > .....

.....

City > ..... Postcode > .....

Phone number > .....

☐ Orchards

☐ Oil production

Email > .....

☐ Vine growing

☐ Parks & gardens

Purchase date > ..... / ..... / .....

Serial number v - Ref > .....

--	--	--	--	--	--	--	--

Remarks > .....

Dealer's stamp

Serial number

--	--	--	--	--	--	--	--

**DEALER**

To be kept by the dealer  
for the customer  
file  
customer file



--

--



# EQUIPMENT MANUFACTURED IN FRANCE



Manufacturer > **INFACO S.A.S. - 81140 CAHUZAC-SUR-VÈRE (FRANCE)**

Type > **OLIVE HARVESTER**

Ref > **E500012V2 / E500012V2T**

Weight > **E500012V2 2750g / E500012V2T 3250g**

Maximum power > **200 W**

Battery rated voltage > **12 Volts**

These specifications are given as an indication only. Under no circumstances may they be considered as contractually binding. They are subject to modification without prior notice in the interests of product development.

## TECHNICAL INFORMATION OR CUSTOMER SERVICE

INFACO S.A.S.

Bois de Roziès

81140 CAHUZAC-SUR VÈRE France

**Phone:** (+33) 05 63 33 91 49 - **Fax:** (+33) 05 63 33 95 57

**Email:** [contact@infaco.fr](mailto:contact@infaco.fr)

Technical videos available on the website: **[www.infaco.com](http://www.infaco.com)**

# DÉCLARATION DE CONFORMITÉ CE

## DECLARATION OF CONFORMITY (CE)

**INFACO s.a.s. déclare que le matériel neuf désigné ci-après :**  
*INFACO S.A.S. declares that the new equipment designated below:*

**Appareil électrique INFACO**  
*Electric device INFACO*

**De marque > INFACO**  
*Brand name*

**Modèle > E500012V2 / E500012V2T**  
*Model*

**N° de série >**  
*Serial no*

**Année de fabrication >**  
*Year of manufacture*

**Est conforme aux dispositifs des directives :**  
*Complies with the provisions of the directives for:*

- « Machines » (directive 2006/42/CEE).  
*Appliances" (directive 2006/42/CEE).*
- « Émissions sonores machines utilisées en extérieur » directive 2000/14/CE (arrêté du 18 mars 2002) modifiée par la 2005/88/CE (arrêté du 22 mai 2006).

*Directive 2001/14/EC « on the noise emission by equipment for use outdoors » (order of 18 march 2002) modified by the directive 2005/88/EC (order of 22 may 2006).*

### E500012V2 / E500012V2T

Niveau de pression acoustique pondéré A au poste de travail, LpA (NF EN 60745-2-11 : 2009) 82 dB(A)  
*Sound pressure level, LpA (NF EN 60745-2-11 : 2009)*

*Incertitude Uncertainty*

*KpA 3 dB(A)*

Valeur mesurée d'émission vibratoire, ah (NF EN 12096) 8,6 m/s<sup>2</sup>  
*Measured vibration emission value, ah (NF EN 12096)*

*Incertitude Uncertainty*

*1,5 m/s<sup>2</sup>*

- La personne autorisée à constituer le dossier technique au sein d'INFACO est M. ALVAREZ Grégory.  
*The person authorized to compile the technical file within the company INFACO is Mr. Gregory ALVAREZ.*

**Fait à > CAHUZAC SUR VERE**  
*Signed in*

**LE > 01/02/2022**  
*Date*

**M. DELMAS Davy, Président de la Société INFACO**  
*M. DELMAS Davy, INFACO Managing Director*

**Signature**



INFACO s'engage à fournir aux autorités nationales les informations pertinentes concernant la machine.  
*INFACO undertakes to provide national authorities with all relevant information concerning the machine.*





[www.infaco.com](http://www.infaco.com)

EN - User guide - Olive Harvester **E500012V2 / E500012V2T**

*NOT\_E500012V2-T\_EN\_07\_22*